

PARRISH BRANCH

COUNTY:HOLMES
STATE:FL
ACRES: 242.2

Map Scale 1 in :3960 ft
Reference Scale 1:47520

0 1980 ft 3960 ft



AFM REAL ESTATE

AFM Real Estate
AFMRealEstate.com

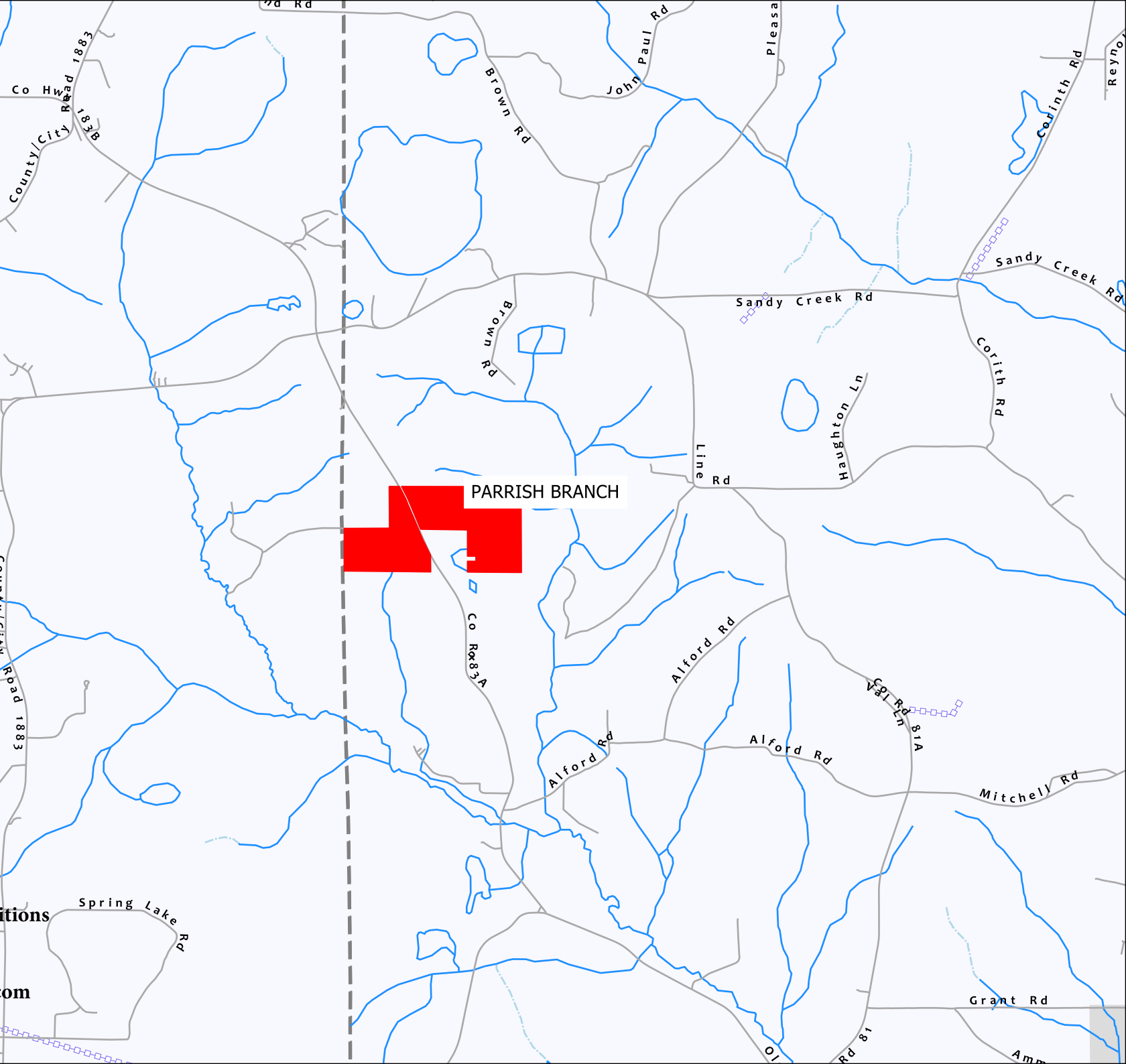

PARRISH BRANCH

Contact:
Tony Mitchell
Real Estate Sales & Acquisitions
Licensed FL & AL
850.526.8466
tony.mitchell@afmforest.com

This product is for informational purposes and may not have been prepared for, or suitable for legal, engineering or survey purposes. Users should review or consult the primary data sources to ascertain the usability of the information.